

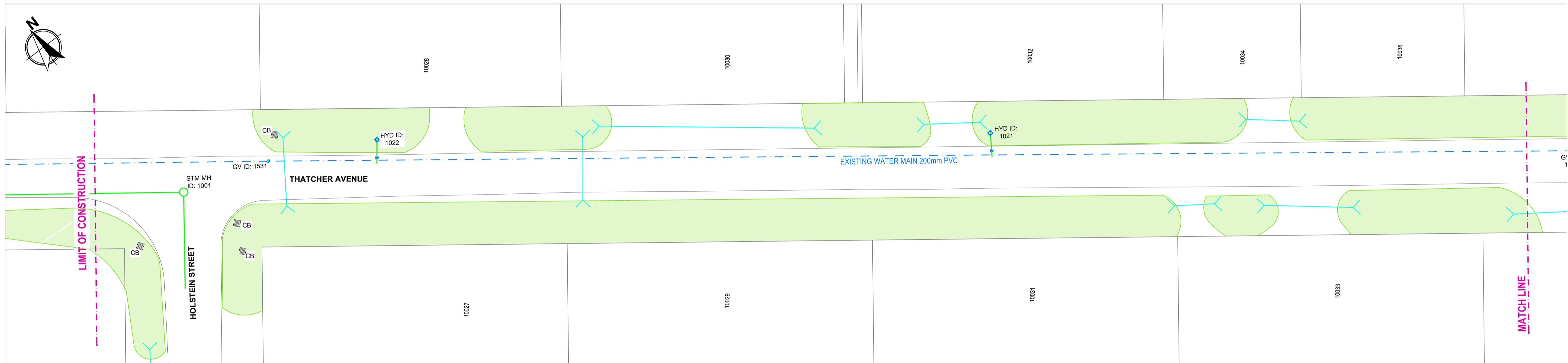

EXISTING ROAD & DITCH LAYOUT

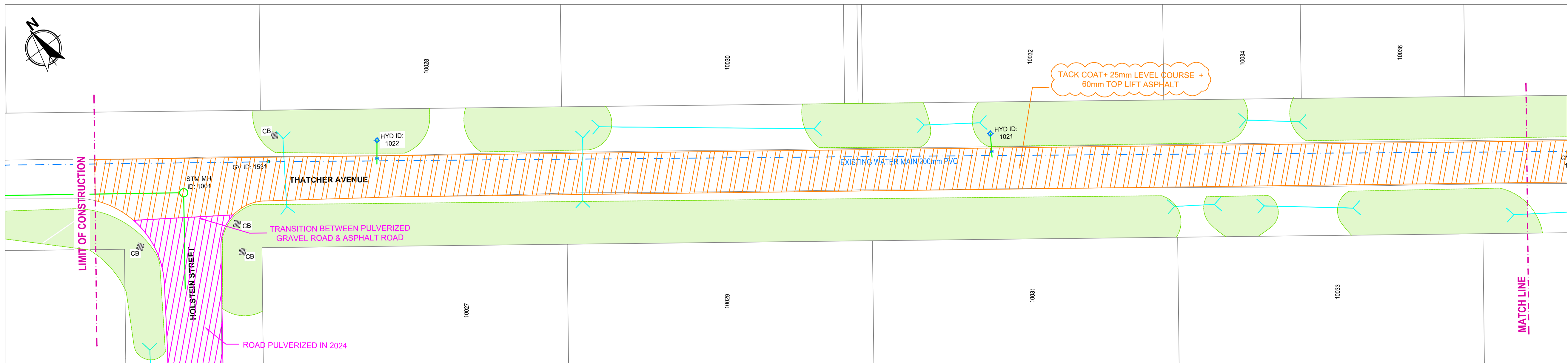

UNDERGROUND LAYOUT



PAVING PLAN

LEGEND

- EXISTING FIRE HYDRANT
- EXISTING HYDRANT VALVE
- EXISTING WATER MAIN VALVE
- EXISTING STORM SEWER MANHOLE
- EXISTING CATCH BASIN
- EXISTING CULVERT
- PROPOSED CULVERT
- LEVEL COURSE + ASPHALT OVERLAY PAVING
- SHAPEBLADE + BASE GRAVEL + ASPHALT PAVING
- EXISTING DITCHES
- PROPOSED DITCHES

GENERAL NOTES

1. ALL UNITS ARE IN METERS UNLESS SPECIFIED.
2. ALL UTILITIES SHOWN ARE IN APPROXIMATE LOCATIONS AND MUST BE FIELD VERIFIED PRIOR TO CONSTRUCTION.
3. LOCATIONS AND QUANTITIES TO BE FIELD VERIFIED PRIOR TO WORK COMMENCING.
4. THE TENDER DRAWING PACKAGE IS THE PROPERTY OF THE CITY OF NORTH BATTLEFORD. ANY MODIFICATIONS MUST BE APPROVED OF BY THE CITY OF NORTH BATTLEFORD.

PROJECT NOTES

1. THATCHER AVENUE TO BE OVERLAID WITH LEVEL COURSE & ASPHALT, NO MILLING REQUIRED
2. HOLSTEIN AND MARQUIS AVENUE HAS BEEN PULVERIZED IN 2024. ROAD IS TO BE BLADED AND SHAPED BEFORE INSTALL OF BASE GRAVEL AND PAVING.
3. THE CITY RECOGNIZES THAT THERE WILL BE A LOSS OF APPROXIMATELY 25mm THICKNESS OF MATERIAL DURING THE BLADING/SHAPING PHASE OF MARQUIS AND HOLSTEIN.
4. COMBRIGD AND ROUGH FINISHED CONCRETE TO BE INSTALLED ON ALL NEW CULVERT OPENINGS TO MITIGATE VEGETATION GROWTH
5. DITCH WORK TO BE DONE ONLY IN APPROVED LOCATIONS. ADDITIONAL DITCHWORK SHOULD ONLY BE DONE TO RECTIFY DRAINAGE. TO BE APPROVED BY ENGINEER.
6. NEW DITCHES TO BE INSTALLED IN FRONT OF 10039 & 10041 THATCHER AVENUE. MAX NO. OF ALLOWED DRIVEWAYS PER FRONTAGE IS 2 @ 15m WIDTH
7. ALL ASPHALT BUT JOINTS TO BE CROSS ROLLED TO ALLOW FOR SEAMLESS TRANSITIONS

REVISION HISTORY

NO.	DESCRIPTION	DATE
00	ISSUED FOR TENDER	2026-05-11

North Battleford
Treaty Six Territory | Heartland of the West | Saskatchewan | Canada

ISSUED FOR TENDER

PROJECT TITLE

PARSONS INDUSTRIAL PARK REHABILITATION

DRAWING TITLE:
THATCHER AVENUE - SEGMENT 1

DRAWING SUBTITLE:
DITCH & CULVERT REHABILITATION/LEVEL COURSE AND TOP LIFT ASPHALT PAVING

DRAWING NO: 26U-PIP-PAV-101	REV: 00
PLOT DATE: 2026/05/11	SHEET NO: 01 OF 06



EXISTING ROAD & DITCH LAYOUT

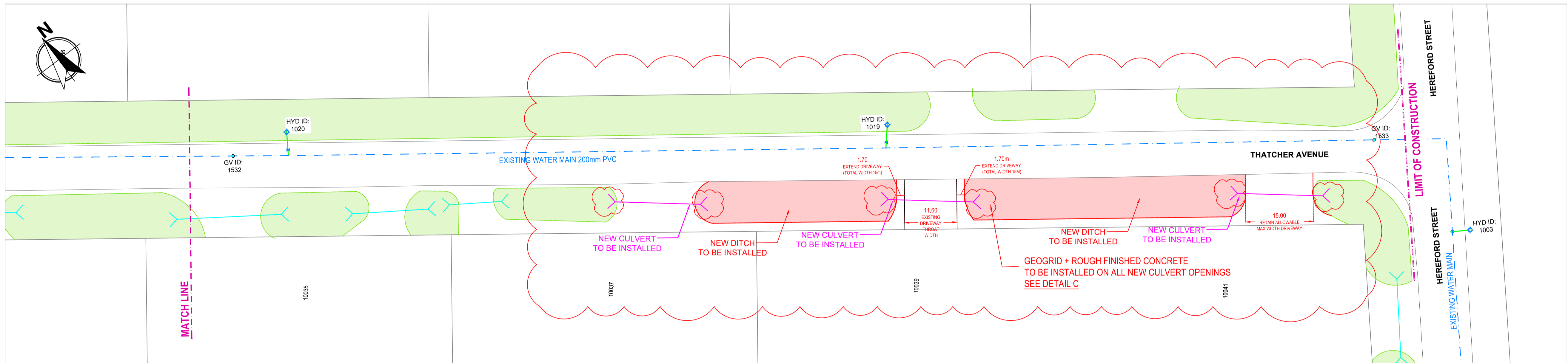

UNDERGROUND & CULVERT REHABILITATION - INSTALLATION OF NEW CULVERTS AND NEW DITCHES

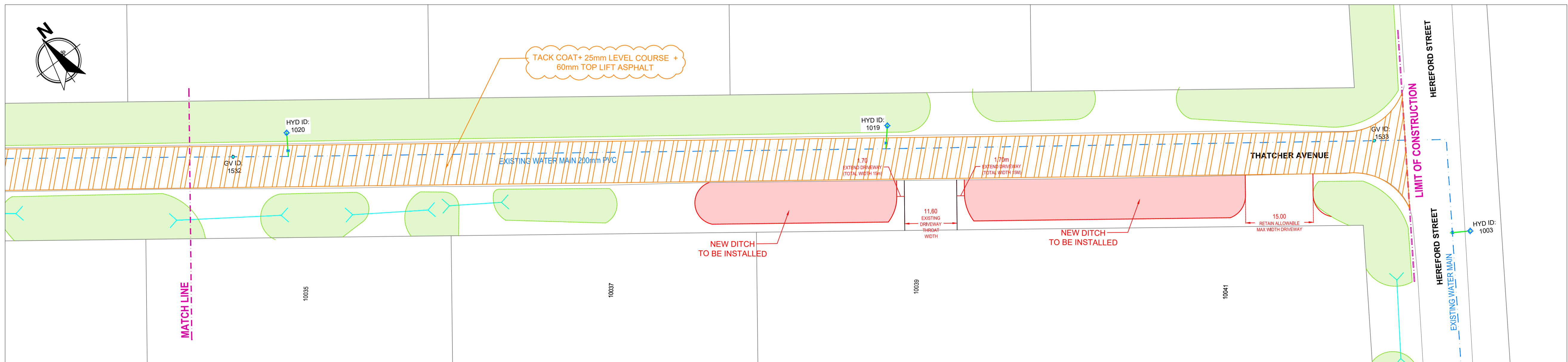

PAVING PLAN

LEGEND

- EXISTING FIRE HYDRANT
- EXISTING HYDRANT VALVE
- EXISTING WATER MAIN VALVE
- EXISTING STORM SEWER MANHOLE
- EXISTING CATCH BASIN
- EXISTING CULVERT
- PROPOSED CULVERT
- LEVEL COURSE + ASPHALT OVERLAY PAVING
- SHAPEBLADE + BASE GRAVEL + ASPHALT PAVING
- EXISTING DITCHES
- PROPOSED DITCHES

- GENERAL NOTES
1. ALL UNITS ARE IN METERS UNLESS SPECIFIED.
 2. ALL UTILITIES SHOWN ARE IN APPROXIMATE LOCATIONS AND MUST BE FIELD VERIFIED PRIOR TO CONSTRUCTION.
 3. LOCATIONS AND QUANTITIES TO BE FIELD VERIFIED PRIOR TO WORK COMMENCING.
 4. THE TENDER DRAWING PACKAGE IS THE PROPERTY OF THE CITY OF NORTH BATTLEFORD. ANY MODIFICATIONS MUST BE APPROVED BY THE CITY OF NORTH BATTLEFORD.

- PROJECT NOTES
1. THATCHER AVENUE TO BE OVERLAID WITH LEVEL COURSE + ASPHALT, NO MILLING REQUIRED
 2. HOLSTEIN AND MARQUIS AVENUE HAS BEEN PULVERIZED IN 2024. ROAD IS TO BE BLADED AND SHAPED BEFORE INSTALL OF BASE GRAVEL AND PAVING.
 3. THE CITY RECOGNIZES THAT THERE WILL BE A LOSS OF APPROXIMATELY 25mm THICKNESS OF MATERIAL DURING THE BLADING/SHPING PHASE OF MARQUIS AND HOLSTEIN.
 4. COMBRIGD AND ROUGH FINISHED CONCRETE TO BE INSTALLED ON ALL NEW CULVERT OPENINGS TO MITIGATE VEGETATION GROWTH
 5. DITCH WORK TO BE DONE ONLY IN APPROVED LOCATIONS. ADDITIONAL DITCHWORK SHOULD ONLY BE DONE TO RECTIFY DRAINAGE. TO BE APPROVED BY ENGINEER.
 6. NEW DITCHES TO BE INSTALLED IN FRONT OF 10039 & 10041 THATCHER AVENUE. MAX NO. OF ALLOWED DRIVEWAYS PER FRONTAGE IS 2 @ 15m WIDTH
 7. ALL ASPHALT BUT JOINTS TO BE CROSS ROLLED TO ALLOW FOR SEAMLESS TRANSITIONS

REVISION HISTORY

NO.	DESCRIPTION	DATE
00	ISSUED FOR TENDER	2026-05-11



ISSUED FOR TENDER

PROJECT TITLE
PARSONS INDUSTRIAL PARK REHABILITATION

DRAWING TITLE:
THATCHER AVENUE - SEGMENT 2

DRAWING SUBTITLE:
DITCH & CULVERT REHABILITATION/LEVEL COURSE AND TOP LIFT ASPHALT PAVING

DRAWING NO: 26U-PIP-PAV-102	REV: 00
PLOT DATE: 2026/05/11	SHEET NO. OF 02 OF 06



EXISTING ROAD & DITCH LAYOUT

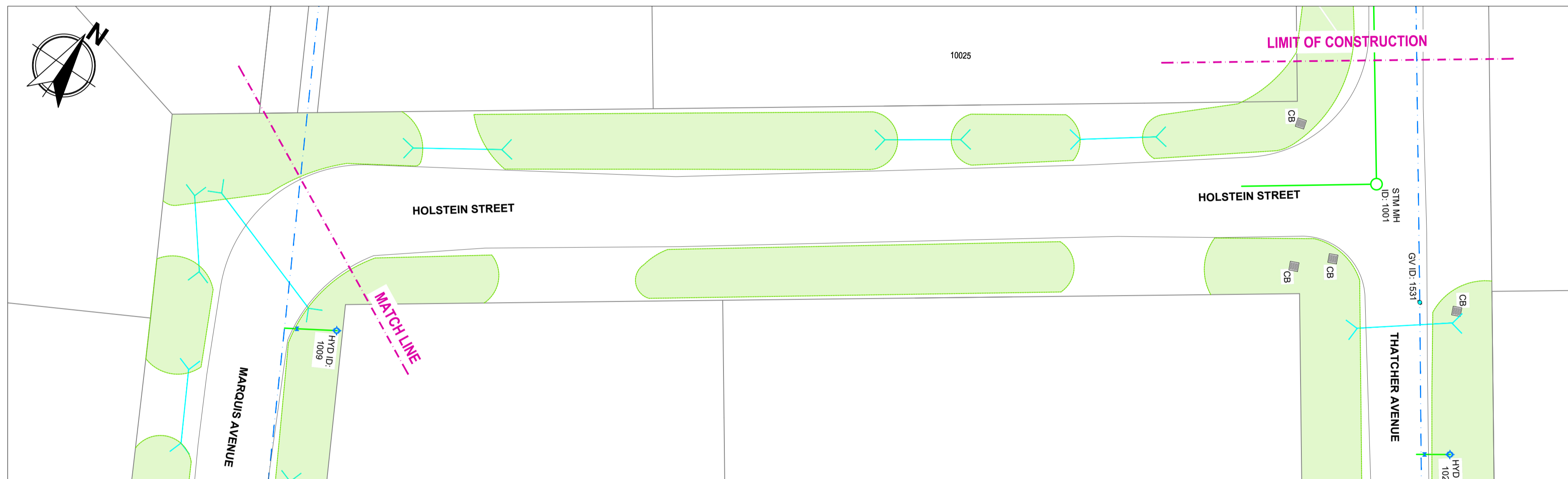

UNDERGROUND LAYOUT

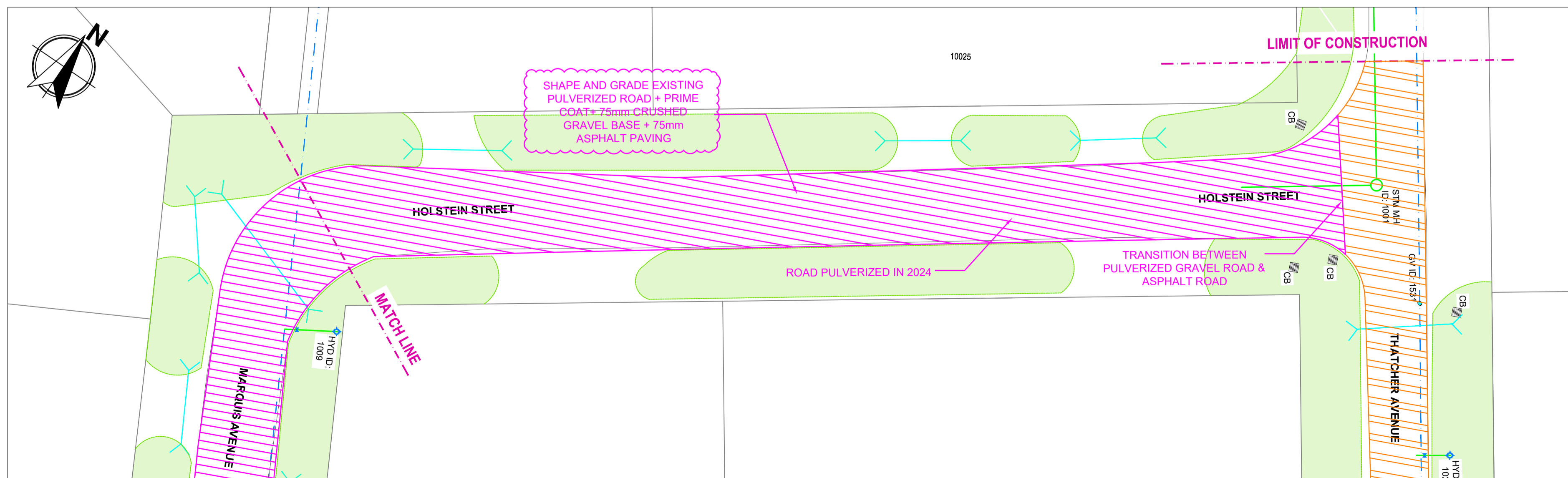

PAVING PLAN

LEGEND

	EXISTING FIRE HYDRANT
	EXISTING HYDRANT VALVE
	EXISTING WATER MAIN VALVE
	EXISTING STORM SEWER MANHOLE
	EXISTING CATCH BASIN
	EXISTING CULVERT
	PROPOSED CULVERT
	LEVEL COURSE + ASPHALT OVERLAY PAVING
	SHAPEBLADE + BASE GRAVEL + ASPHALT PAVING
	EXISTING DITCHES
	PROPOSED DITCHES

- GENERAL NOTES
1. ALL UNITS ARE IN METERS UNLESS SPECIFIED.
 2. ALL UTILITIES SHOWN ARE IN APPROXIMATE LOCATIONS AND MUST BE FIELD VERIFIED PRIOR TO CONSTRUCTION.
 3. LOCATIONS AND QUANTITIES TO BE FIELD VERIFIED PRIOR TO WORK COMMENCING.
 4. THE TENDER DRAWING PACKAGE IS THE PROPERTY OF THE CITY OF NORTH BATTLEFORD. ANY MODIFICATIONS MUST BE APPROVED OF BY THE CITY OF NORTH BATTLEFORD.

- PROJECT NOTES
1. THATCHER AVENUE TO BE OVERLAID WITH LEVEL COURSE & ASPHALT, NO MILLING REQUIRED
 2. HOLSTEIN AND MARQUIS AVENUE HAS BEEN PULVERIZED IN 2024. ROAD IS TO BE BLADED AND SHAPED BEFORE INSTALL OF BASE GRAVEL AND PAVING.
 3. THE CITY RECOGNIZES THAT THERE WILL BE A LOSS OF APPROXIMATELY 25mm THICKNESS OF MATERIAL DURING THE BLADING/SHAPING PHASE OF MARQUIS AND HOLSTEIN.
 4. COMBGRID AND ROUGH FINISHED CONCRETE TO BE INSTALLED ON ALL NEW CULVERT OPENINGS TO MITIGATE VEGETATION GROWTH
 5. DITCH WORK TO BE DONE ONLY IN APPROVED LOCATIONS. ADDITIONAL DITCHWORK SHOULD ONLY BE DONE TO RECTIFY DRAINAGE. TO BE APPROVED BY ENGINEER.
 6. NEW DITCHES TO BE INSTALLED IN FRONT OF 10039 & 10041 THATCHER AVENUE. MAX NO. OF ALLOWED DRIVEWAYS PER FRONTAGE IS 2 @ 15m WIDTH
 7. ALL ASPHALT BUT JOINTS TO BE CROSS ROLLED TO ALLOW FOR SEAMLESS TRANSITIONS

REVISION HISTORY

NO.	DESCRIPTION	DATE
00	ISSUED FOR TENDER	2026-05-11



ISSUED FOR TENDER

PROJECT TITLE

PARSONS INDUSTRIAL PARK REHABILITATION

DRAWING TITLE:
HOLSTEIN STREET

DRAWING SUBTITLE:
SHAPE PULVERIZED GRAVEL ROAD AND ASPHALT PAVING

DRAWING NO: 26U-PIP-PAV-103	REV: 00
PLOT DATE: 2026/05/11	SHEET NO: 03 OF 06



EXISTING ROAD & DITCH LAYOUT

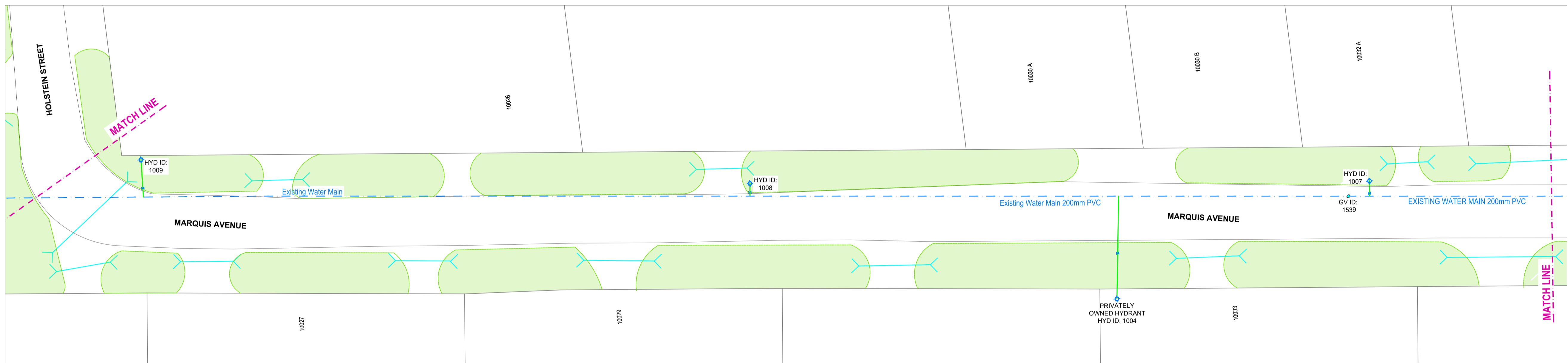

UNDERGROUND

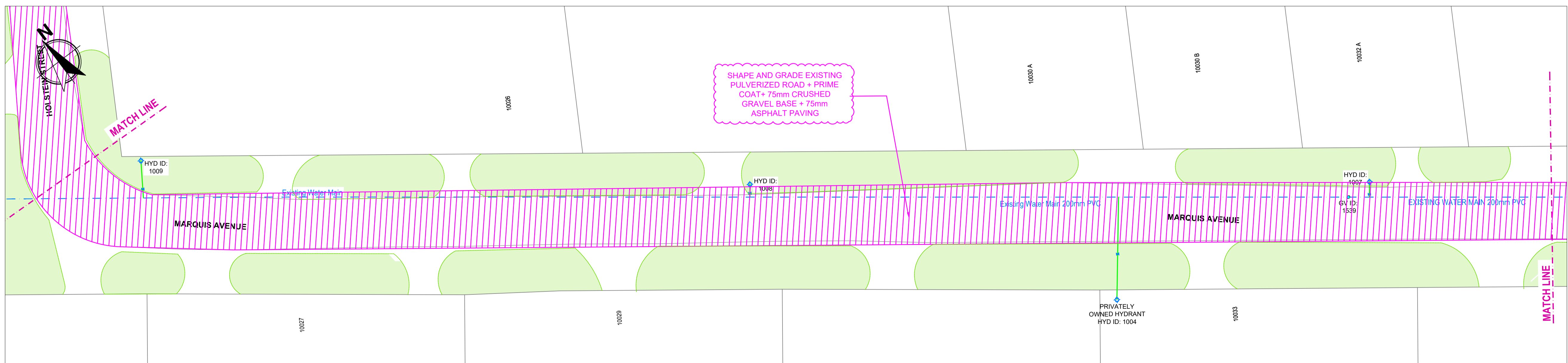

PAVING PLAN

LEGEND

- EXISTING FIRE HYDRANT
- EXISTING HYDRANT VALVE
- EXISTING WATER MAIN VALVE
- EXISTING STORM SEWER MANHOLE
- EXISTING CATCH BASIN
- EXISTING CULVERT
- PROPOSED CULVERT
- LEVEL COURSE + ASPHALT OVERLAY PAVING
- SHAPEBLADE + BASE GRAVEL + ASPHALT PAVING
- EXISTING DITCHES
- PROPOSED DITCHES

- GENERAL NOTES
- ALL UNITS ARE IN METERS UNLESS SPECIFIED.
 - ALL UTILITIES SHOWN ARE IN APPROXIMATE LOCATIONS AND MUST BE FIELD VERIFIED PRIOR TO CONSTRUCTION.
 - LOCATIONS AND QUANTITIES TO BE FIELD VERIFIED PRIOR TO WORK COMMENCING.
 - THE TENDER DRAWING PACKAGE IS THE PROPERTY OF THE CITY OF NORTH BATTLEFORD. ANY MODIFICATIONS MUST BE APPROVED BY THE CITY OF NORTH BATTLEFORD.

- PROJECT NOTES
- THATCHER AVENUE TO BE OVERLAID WITH LEVEL COURSE & ASPHALT, NO MILLING REQUIRED.
 - HOLSTEIN AND MARQUIS AVENUE HAS BEEN PULVERIZED IN 2024. ROAD IS TO BE BLADED AND SHAPED BEFORE INSTALL OF BASE GRAVEL AND PAVING.
 - THE CITY RECOGNIZES THAT THERE WILL BE A LOSS OF APPROXIMATELY 25mm THICKNESS OF MATERIAL DURING THE BLADING/SHAPING PHASE OF MARQUIS AND HOLSTEIN.
 - COMBRIGRD AND ROUGH FINISHED CONCRETE TO BE INSTALLED ON ALL NEW CULVERT OPENINGS TO MITIGATE VEGETATION GROWTH.
 - DITCH WORK TO BE DONE ONLY IN APPROVED LOCATIONS. ADDITIONAL DITCHWORK SHOULD ONLY BE DONE TO RECTIFY DRAINAGE. TO BE APPROVED BY ENGINEER.
 - NEW DITCHES TO BE INSTALLED IN FRONT OF 10039 & 10041 THATCHER AVENUE. MAX NO. OF ALLOWED DRIVEWAYS PER FRONTAGE IS 2 @ 15m WIDTH.
 - ALL ASPHALT BUT JOINTS TO BE CROSS ROLLED TO ALLOW FOR SEAMLESS TRANSITIONS.

REVISION HISTORY

NO.	DESCRIPTION	DATE
00	ISSUED FOR TENDER	2026-05-11



ISSUED FOR TENDER

PROJECT TITLE
PARSONS INDUSTRIAL PARK REHABILITATION

DRAWING TITLE:
MARQUIS AVENUE - SEGMENT 1

DRAWING SUBTITLE:
SHAPE PULVERIZED GRAVEL ROAD AND ASPHALT PAVING

DRAWING NO: 26U-PIP-PAV-104	REV: 00
PLOT DATE: 2026/05/08	SHEET NO: 04 OF 06



EXISTING ROAD & DITCH LAYOUT

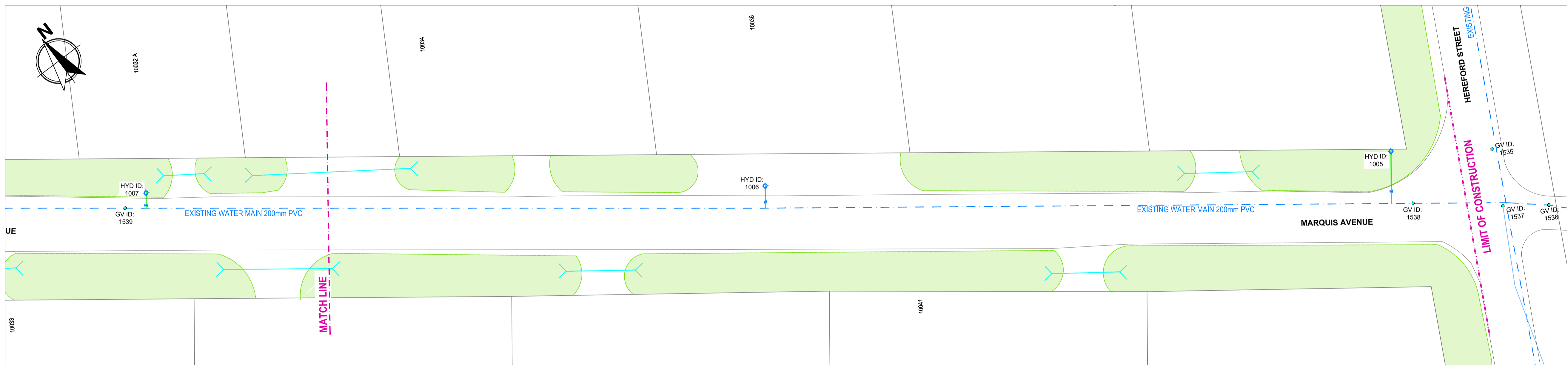

UNDERGROUND

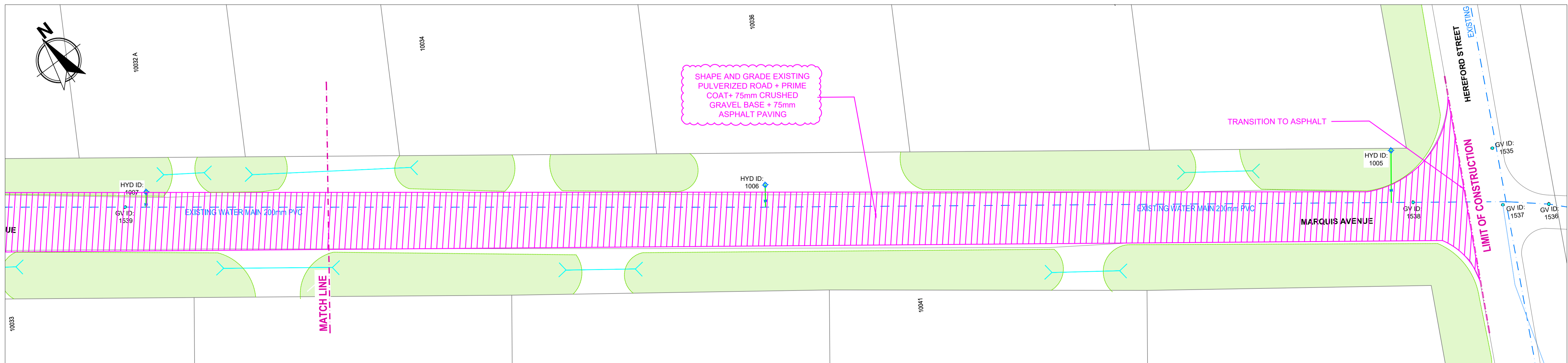

PAVING PLAN

LEGEND

	EXISTING FIRE HYDRANT
	EXISTING HYDRANT VALVE
	EXISTING WATER MAIN VALVE
	EXISTING STORM SEWER MANHOLE
	EXISTING CATCH BASIN
	EXISTING CULVERT
	PROPOSED CULVERT
	LEVEL COURSE + ASPHALT OVERLAY PAVING
	SHAPEBLADE + BASE GRAVEL + ASPHALT PAVING
	EXISTING DITCHES
	PROPOSED DITCHES

GENERAL NOTES

- ALL UNITS ARE IN METERS UNLESS SPECIFIED.
- ALL UTILITIES SHOWN ARE IN APPROXIMATE LOCATIONS AND MUST BE FIELD VERIFIED PRIOR TO CONSTRUCTION.
- LOCATIONS AND QUANTITIES TO BE FIELD VERIFIED PRIOR TO WORK COMMENCING.
- THE TENDER DRAWING PACKAGE IS THE PROPERTY OF THE CITY OF NORTH BATTLEFORD, ANY MODIFICATIONS MUST BE APPROVED OF BY THE CITY OF NORTH BATTLEFORD.

PROJECT NOTES

- THATCHER AVENUE TO BE OVERLAID WITH LEVEL COURSE & ASPHALT, NO MILLING REQUIRED.
- HOLSTEIN AND MARQUIS AVENUE HAS BEEN PULVERIZED IN 2024. ROAD IS TO BE BLADED AND SHAPED BEFORE INSTALL OF BASE GRAVEL AND PAVING.
- THE CITY RECOGNIZES THAT THERE WILL BE A LOSS OF APPROXIMATELY 25mm THICKNESS OF MATERIAL DURING THE BLADING/SHAPING PHASE OF MARQUIS AND HOLSTEIN.
- COMBGRID AND ROUGH FINISHED CONCRETE TO BE INSTALLED ON ALL NEW CULVERT OPENINGS TO MITIGATE VEGETATION GROWTH.
- DITCH WORK TO BE DONE ONLY IN APPROVED LOCATIONS. ADDITIONAL DITCHWORK SHOULD ONLY BE DONE TO RECTIFY DRAINAGE. TO BE APPROVED BY ENGINEER.
- NEW DITCHES TO BE INSTALLED IN FRONT OF 10039 & 10041 THATCHER AVENUE. MAX NO. OF ALLOWED DRIVEWAYS PER FRONTAGE IS 2 @ 15m WIDTH.
- ALL ASPHALT BUT JOINTS TO BE CROSS ROLLED TO ALLOW FOR SEAMLESS TRANSITIONS.

REVISION HISTORY

NO.	DESCRIPTION	DATE
00	ISSUED FOR TENDER	2026-05-11

North Battleford
 Treaty Six Territory | Heartland of the West | Saskatchewan | Canada

ISSUED FOR TENDER

PROJECT TITLE
PARSONS INDUSTRIAL PARK REHABILITATION

DRAWING TITLE:
MARQUIS AVENUE - SEGMENT 2

DRAWING SUBTITLE:
SHAPE PULVERIZED GRAVEL ROAD AND ASPHALT PAVING

DRAWING NO:
 26U-PIP-PAV-105

PLOT DATE:
 2026/05/11

SCALE:
 1:500

REV:
 00

SHEET NO:
 05 OF 06

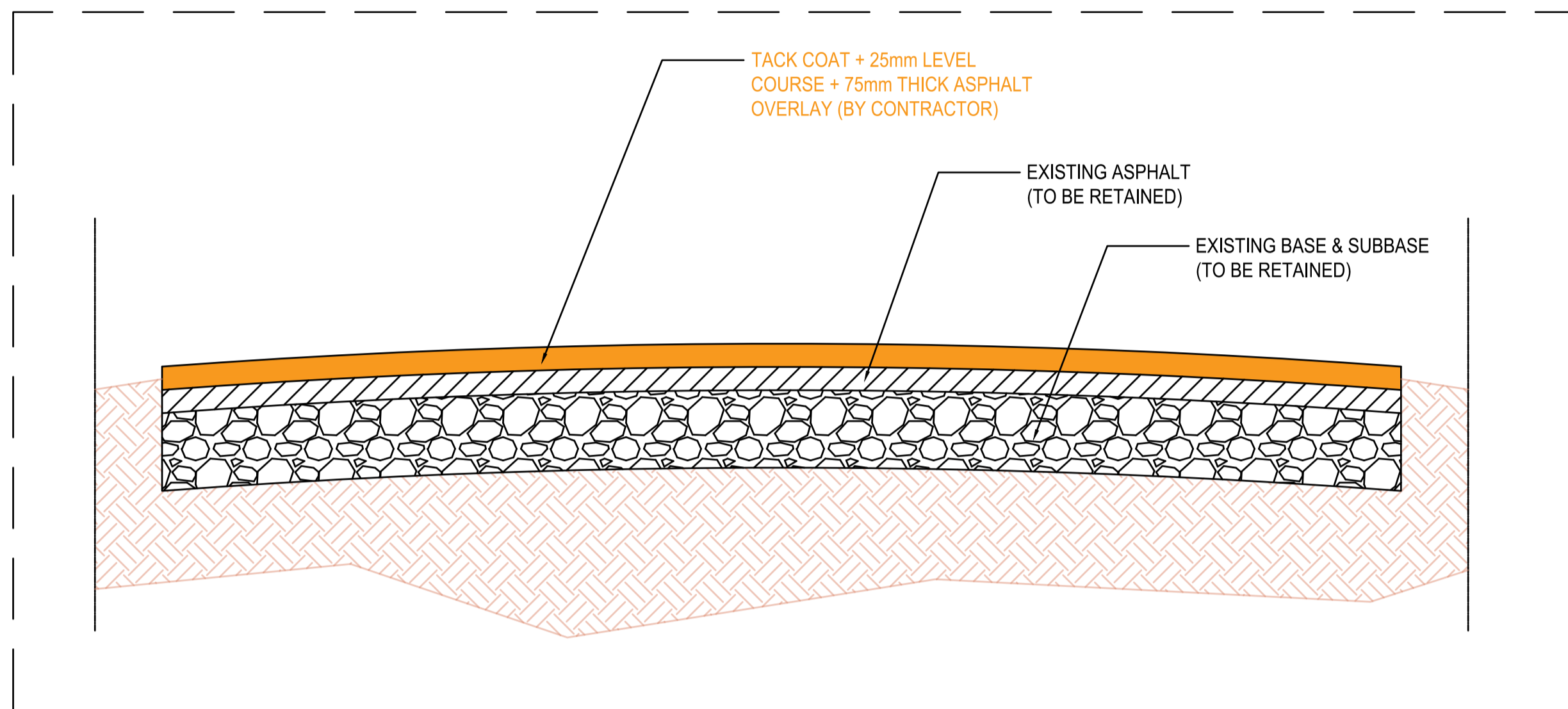

DETAIL A - THATCHER AVENUE PAVING DETAIL
 ASPHALT OVERLAY PAVING OVER EXISTING ASPHALT

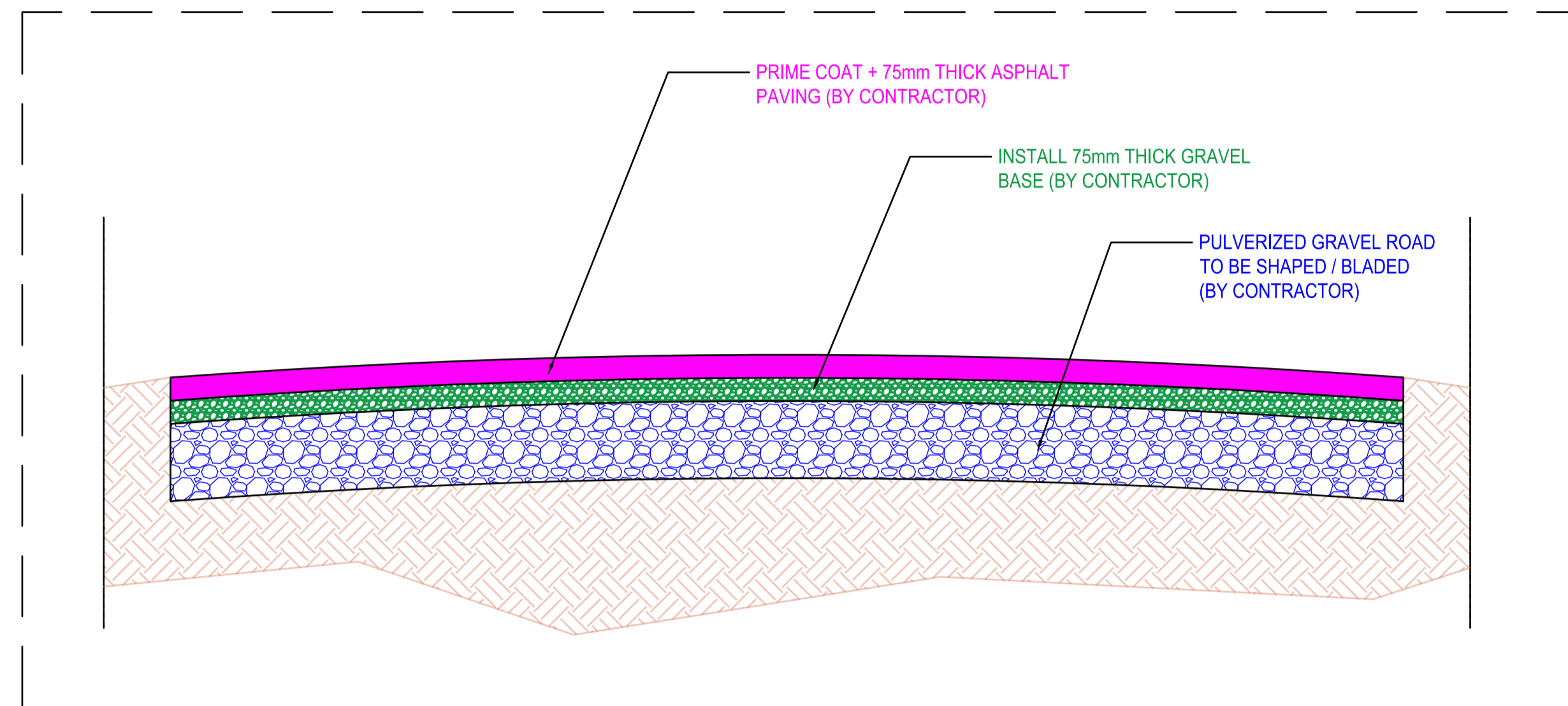

DETAIL B - HOLSTEIN & MARQUIS AVENUE PAVING
 BASE + ASPHALT OVERLAY OVER EXISTING PULVERIZED GRAVEL ROAD

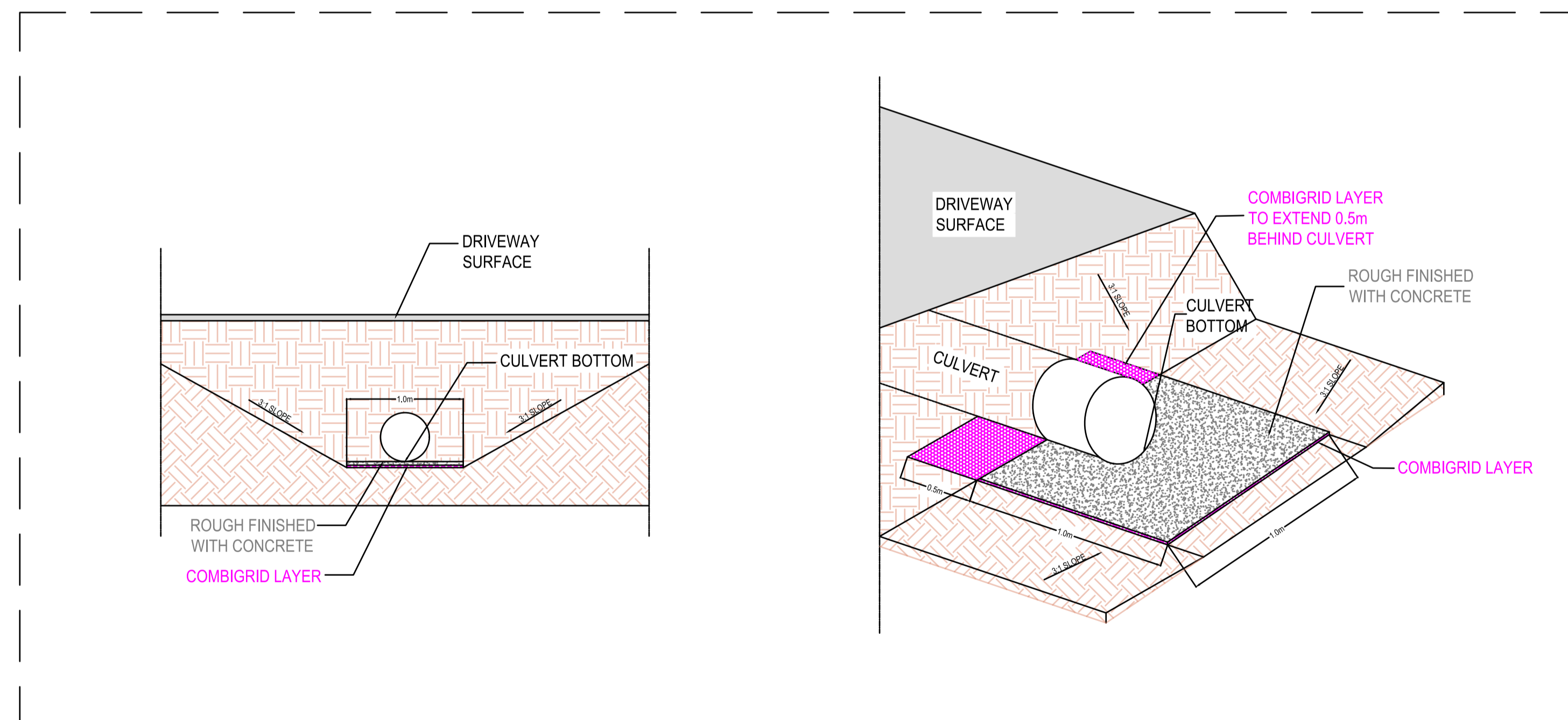

DETAIL C - CULVERT OPENING DETAIL
 INSTALLATION OF COMBIGRID LAYER + ROUGH FINISHED CONCRETE AT ALL CULVERT OPENINGS

LEGEND

- EXISTING FIRE HYDRANT
- EXISTING HYDRANT VALVE
- EXISTING WATER MAIN VALVE
- EXISTING STORM SEWER MANHOLE
- EXISTING CATCH BASIN
- EXISTING CULVERT
- PROPOSED CULVERT
- LEVEL COURSE + ASPHALT OVERLAY PAVING
- SHAPEBLADE + BASE GRAVEL + ASPHALT PAVING
- EXISTING DITCHES
- PROPOSED DITCHES

- GENERAL NOTES
1. ALL UNITS ARE IN METERS UNLESS SPECIFIED.
 2. ALL UTILITIES SHOWN ARE IN APPROXIMATE LOCATIONS AND MUST BE FIELD VERIFIED PRIOR TO CONSTRUCTION.
 3. LOCATIONS AND QUANTITIES TO BE FIELD VERIFIED PRIOR TO WORK COMMENCING.
 4. THE TENDER DRAWING PACKAGE IS THE PROPERTY OF THE CITY OF NORTH BATTLEFORD. ANY MODIFICATIONS MUST BE APPROVED OF BY THE CITY OF NORTH BATTLEFORD.

- PROJECT NOTES
1. THATCHER AVENUE TO BE OVERLAID WITH LEVEL COURSE & ASPHALT, NO MILLING REQUIRED
 2. HOLSTEIN AND MARQUIS AVENUE HAS BEEN PULVERIZED IN 2024. ROAD IS TO BE BLADED AND SHAPED BEFORE INSTALL OF BASE GRAVEL AND PAVING.
 3. THE CITY RECOGNIZES THAT THERE WILL BE A LOSS OF APPROXIMATELY 25mm THICKNESS OF MATERIAL DURING THE BLADING/SHAPING PHASE OF MARQUIS AND HOLSTEIN.
 4. COMBIGRID AND ROUGH FINISHED CONCRETE TO BE INSTALLED ON ALL NEW CULVERT OPENINGS TO MITIGATE VEGETATION GROWTH
 5. DITCH WORK TO BE DONE ONLY IN APPROVED LOCATIONS. ADDITIONAL DITCHWORK SHOULD ONLY BE DONE TO RECTIFY DRAINAGE. TO BE APPROVED BY ENGINEER.
 6. NEW DITCHES TO BE INSTALLED IN FRONT OF 10039 & 10041 THATCHER AVENUE. MAX NO. OF ALLOWED DRIVEWAYS PER FRONTAGE IS 2 @ 15m WIDTH
 7. ALL ASPHALT BUT JOINTS TO BE CROSS ROLLED TO ALLOW FOR SEAMLESS TRANSITIONS

REVISION HISTORY

NO.	DESCRIPTION	DATE
00	ISSUED FOR TENDER	2026-05-11



ISSUED FOR TENDER

PROJECT TITLE

PARSONS INDUSTRIAL PARK REHABILITATION

DRAWING TITLE:
 DETAILS

DRAWING SUBTITLE:

DRAWING NO: 26U-PIP-PAV-106	REV: 00
PLOT DATE: 2026/05/11	SHEET NO: 06 OF 06